Meeting: Traffic Management Meeting
Date: 19th June 2012
Subject: Stotfold Road, Arlesey - Resolution of representations to the proposed Prohibition of Waiting
Report of: Basil Jackson, Assistant Director of Highways and Transportation.
Summary: To report to the Executive Member for Sustainable Communities Services the receipt of representations to proposals for a Prohibition of Waiting on lengths of Stotfold Road, Arlesey and seek the Executive Member's views.

Contact Officer: Gary Baldwin – Traffic Engineer
gary.baldwin@amey.co.uk
Public/Exempt: Public
Wards Affected: Arlesey
Function of: Council

CORPORATE IMPLICATIONS

Council Priorities:

To improve highway safety and facilitate the free flow of traffic

Financial:

The cost of introducing the waiting restrictions will be approximately £2,500.

Legal:

None as part of this report

Risk Management:

None as part of this report

Staffing (including Trades Unions):

None as part of this report

Equalities/Human Rights:

None as part of this report

Community Safety:

None as part of this report

Sustainability:

None

RECOMMENDATION(S):

- 1. That the proposal to introduce a Prohibition of Waiting on lengths of Stotfold Road, Arlesey be fully implemented as set out in this report and that the requests for additional lengths of yellow lines be considered as part of the planned Arlesey parking study.**

Background and Information

1. This length of Stotfold Road is the main route into Arlesey from the A507 and is adjacent to the House Lane junction. A prohibition of waiting (double yellow lines) was already in place on both sides of House Lane extending southwards from Stotfold Road. The current proposal is to extend the yellow lines into Stotfold Road to ensure that the whole junction remains clear of parked vehicles.
2. On-street parking is relatively heavy in the area as a result of a nearby shop, garage and the railway station which is within comfortable walking distance. Some of this parking obstructs turning traffic and obscures visibility for road users.
3. Due to the perceived hazard created by parked vehicles around the junction, the double yellow lines have already been installed. However, it is not possible to make the legal Order until the required statutory process is complete, so the restrictions are currently unenforceable.
4. The proposals were formally advertised by public notice in March and April 2012. Consultations were also carried out with the emergency services and other statutory bodies, Parish Council and Elected Members.
5. Three representations have been received all from local residents and these are included in Appendix C. One offers full support and the other two want the restrictions to extend further westwards. The main reasons for asking for additional restrictions are to ensure that the road remains passable when the bus stop is in use and to improve visibility for drivers exiting driveways.
6. Bedfordshire Police accept the proposals and have raised no objection.

Conclusion and the Way Forward

7. The main objective of the proposal was to ensure that the junction of Stotfold Road and House Lane was cleared of parked cars. This objective has been met. The yellow lines were extended further west than would normally be required because of the bus stop. It is accepted that the length of Stotfold Road to the west of House Lane is widely used by commuters avoiding car parking charges at Arlesey railway station. However, commuter parking needs a more thorough investigation as any waiting restrictions proposals are likely to have more wide-ranging implications.

8. Any interference to through-traffic created by buses using the bus stop will be of short duration and is expected to cause very minor inconvenience. The yellow lines that have been installed will have improved visibility for some residents emerging from driveways. Clearly some residents still have visibility concerns, although these have not been made worse by the restrictions.
9. It is recommended that the Traffic Regulation Order is made, so that the restrictions are fully implemented and enforceable. Wider parking issues in Stotford Road can be considered as part of the planned Arlesey parking study, which will be undertaken in the current financial year.

Appendices:

- Appendix A – Location plan
- Appendix B – Public notice
- Appendix C – Representations

APPENDIX A

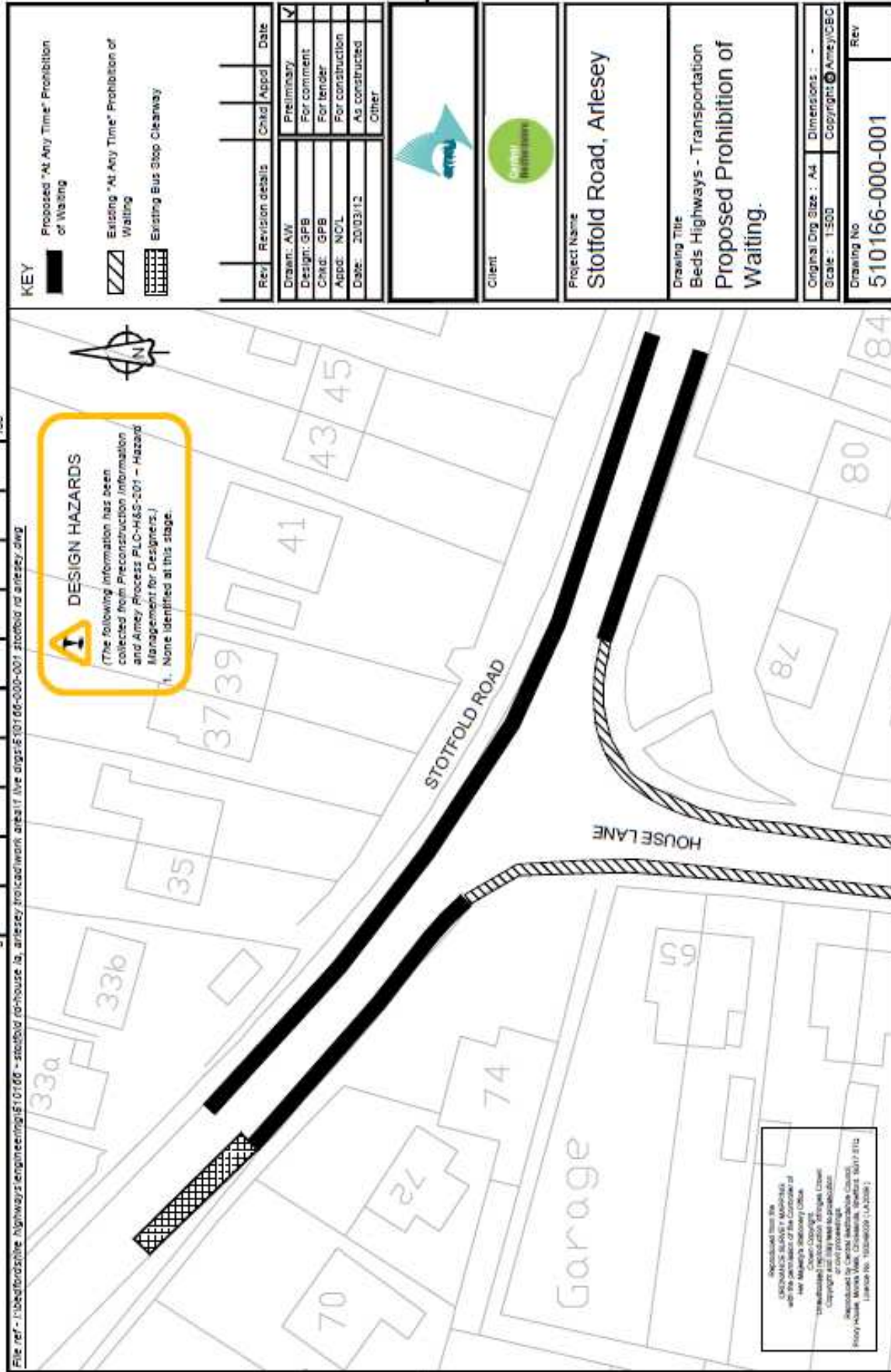

File ref: I:\bedfordshire_highways\engineering\510166 - stotfold rd\work area\11 Ave dgs\510166-000-001 stotfold rd arlesey.dwg

Reproduced from the
 DESIGNALIVE'S SLAVEY MANUSCRIPTS
 with the permission of the Curator of
 the National Library of Scotland
 Copyright © 2012
 Copyright and all other rights reserved
 Reproduced by Oxford Archaeology
 Project House, Monks Walk, Chichester, West Sussex, PO19 1TA
 Licence No: 10220609 (LA2009)



PUBLIC NOTICE

CENTRAL BEDFORDSHIRE COUNCIL PROPOSES TO INTRODUCE A PROHIBITION OF WAITING AT ANY TIME IN STOTFOLD ROAD, ARLESEY

Reason for proposals: The proposed Order is considered necessary on the grounds of promoting road safety. On-street parking near the junction of Stotfold Road and House Lane causes an obstruction to through traffic and reduces visibility for all road users. Waiting is currently prohibited on lengths of House Lane and the proposal is to extend this to cover both sides of Stotfold Road near the junction. Therefore, Central Bedfordshire Council proposes to make a Road Traffic Regulation Order as follows:

Effect of the Order:

To introduce Prohibition of Waiting at any time on the following lengths of road in Arlesey:-

Stotfold Road, both sides, from a point approximately 2 metres south-east of the boundary of nos.70 and 72 Stotfold Road in a south-easterly direction to the boundary of nos.80 and 84 Stotfold Road.

Further Details of the proposal and a plan may be examined during normal opening hours at Arlesey Library, High Street, Arlesey SG15 6SN or online at www.centralbedfordshire.gov.uk/consultations. These details will be placed on deposit until 6 weeks after the Order is made or until it is decided not to continue with the proposal. For more information, please contact Gary Baldwin, tel.0845 3656116 or by email gary.baldwin@amey.co.uk.

Objections should be sent in writing to the Transportation Manager, Bedfordshire Highways, Woodlands Annex, Manton Lane, Bedford MK41 7NU or e-mail centralbedsconsultation@amey.co.uk stating the grounds on which they are made by 23rd April 2012.

Technology House
Amphill Road
Bedford MK42 9QQ

Basil Jackson
Assistant Director for Highways

30th March 2012

APPENDIX C

Dear Sirs

Just like to say that I TOTALLY SUPPORT the prohibition of waiting at any time in Stotfold Road, Arlesey. It has been long overdue, and pleased that it is now moving in the right direction. Access to my driveway will be greatly improved, giving better visibility in both directions.

Yours sincerely

Xxxx Xxxx

I am not sure if this counts as an objection but I want to comment on the proposal.

The plan as far as Stotfold Road is concerned is to have the boundary of the prohibition ending at the boundary of numbers 70 and 72. This is the aspect I wish to comment upon.

I feel the proposed boundary is in the wrong place and I suggest it should be a further 20 or 30 yards to the west, (say) at the boundary of 68 and 66 Stotfold Road. The reasons for suggesting this are :-

1. Immediately opposite 33a is a bus stop and when a bus is stationery the road is blocked to both directions of traffic. Extending the no parking would enable vehicles to pass the stationery bus.
2. The road where the bus stop is situated is narrow and with parked cars is barely wide enough for 2 cars to pass. Indeed I know of 3 accidents in the last 2 weeks in just this area probably caused by the narrow road as much as anything else. With no parked cars in front of 33b and 31 I feel drivers will approach this constriction at a higher speed potentially leading to more accidents.
3. With vehicles parked in front of 33a i.e. the current proposed limit, the driver's view towards the west hides approaching vehicles especially those about 100 yards further on because of the way road bends to the right.
4. I live at XX and share a drive with my neighbours at XX. When exiting my property with cars parked in front of my house, I have to be very vigilant because I am unable to see to my right until the front of my car is part way across the road. With the current proposal in place, I feel drivers approaching from the west are likely to speed up when they see that the road is clear of parked cars beyond my drive so adding to my difficulties. Approaching drivers from the west will have no visual clue that a drive is immediately beyond the last parked car on their left and thus not expect a car to emerge.

I have attached an amended drawing illustrating what I mean.

I hope these comments are fully considered before the proposed order is finalised.

Xxxx Xxxx
XX Stotfold Road
Arlesey
Beds
SG15 6XL

File ref.: \\c:\projects\hdb\hdb\arleyse\arleyse\510166-000-001\510166-000-001.dwg
 0 100

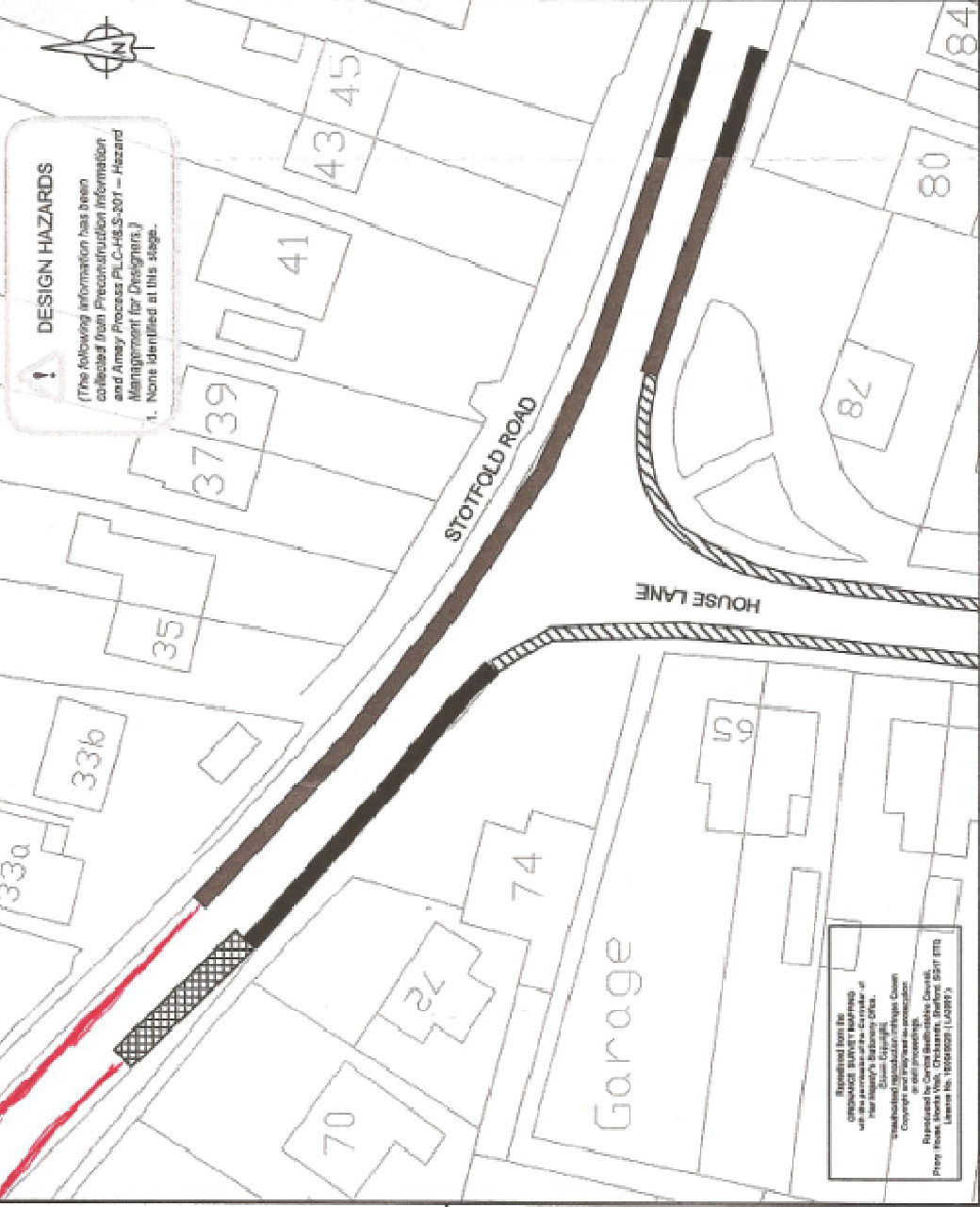

DESIGN HAZARDS
 (The following information has been collected from Preconstruction Information and Arney Process PLC-HLS-301 - Hazard Management for Designers.)
 1. None identified at this stage.

KEY

- Proposed "At Any Time" Prohibition of Waiting
- Existing Bus Stop Cleanway
- Existing "At Any Time" Prohibition of Waiting

| Rev | Revision details | Checked | App'd | Date |
|-----|------------------|---------|-------|------|
| | | | | |

| | | |
|----------------|--|--|
| Drawn: AMW | Checked: GPB | For comment: <input checked="" type="checkbox"/> |
| Design: GPB | Checked: GPB | For tender: <input type="checkbox"/> |
| Aspcd: NOTL | Aspcd: NOTL | For construction: <input type="checkbox"/> |
| Date: 20/03/12 | As constructed: <input type="checkbox"/> | Other: <input type="checkbox"/> |

Client



Project Name
Stotfold Road, Arleyse

Drawing Title
Beds Highways - Transportation Proposed Prohibition of Waiting.

| | |
|--------------------------------------|------------------------|
| Original Dwg Size: A4 | Dimensions: - |
| Scale: 1:500 | Copyright: © Arney/CBC |
| Drawing No: 510166-000-001 | REV |

Reproduced from the copyright material supplied by the author to the publisher by permission of the publisher's statutory agent, Copyright Clearance Center, Inc. 222 Rosewood Drive, Danvers, MA 01923, USA. Reproduced by Carri Ballisbaine Design, Proprietary and Confidential. Drawing No. 10240202 (1) 10/09/12

Dear Gary Baldwin

in reference to the above proposal, may I suggest extending the parking restrictions opposite the bus stop.

When the bus stops the traffic gets blocked both ways when there are cars parked here, the queue usually reaches beyond the House Lane junction.

In addition most of the damage to parked cars occurs at this point, as the road narrows before the bend in the road and there is little room for vehicles to pass safely.

Plus cars coming around the bend, by the garage/House Lane, mount the pavement to avoid oncoming vans and lorries, which are overtaking the parked cars.

Kind regards

Xxxx Xxxx
XX Stotfold Road
Arlesey

